



Illinois Heartland Library System

TO: IHLS Executive Committee
FROM: Leslie Bednar
DATE: April 12, 2021
RE: Edwardsville Building Update

Background

Improvements in our Champaign building delivery area layout a few years ago had a positive impact on delivery efficiency and improved member service. Delivery volume at the Edwardsville building is nearly equal to Champaign's volume, and we wanted to create the same outcome by reconfiguring the delivery space. We faced two challenges: resolution of the primary damage left by mine subsidence and physical dimensions of the delivery area. Our approaches to the challenges were learning opportunities:

- Evaluation by a space planning firm yielded many ideas for improved use of the building; however, our current funding situation cannot support the construction necessary to bring those ideas to life.
- Foundation damage caused by mine subsidence to the north side of the Edwardsville building was repaired by Helitech, Inc. The construction included a new dock inside the garage and polyurethane leveling of the delivery floor area.

In late 2020, IHLS reached out to Color Art to manage the minor building improvements and design updates to surfaces for the first floor of the Edwardsville building. We considered the post COVID-19 office—its hallmarks and requirements for staff health and safety including:

- ergonomics/posture
- physical distancing
- privacy
- cleanable surfaces
- staff organization by function creates efficiencies
- classic and practical design based on job function
- collaboration configurations

Proposal

Attached please find a depiction of the first floor by our Color Art design team. It is a fairly accurate representation of the layout and design with a few details yet to be resolved. The version we will share with you prior to the special board meeting should be the final design and incorporate as many details as possible. We hope this provides sufficient visual information and allows you to envision the space.

Most of the furnishings are manufactured by Steelcase and are under warranty. Our current furniture is Steelcase. The durable pieces have lasted several decades and many layout versions.

IMAGINING TOMORROW ~ DELIVERING POSSIBILITIES TODAY!

We appreciate your patience and support as we work through the process of designing a staff-and budget-friendly workplace. Our hope is that it will serve our needs well now and a couple of decades into the future, too. Please let me know if you have any questions and I will do my best to answer them before the committee meeting. Thank you.



Illinois Heartland Library System

PROJECT EDW 1ST FLOOR
CLIENT NAME ILLINOIS HEARTLAND LIBRARY
DESIGN GINNY HAUMESSER
SALES SHAWNEE BLOCK
PROJECT # 220201 FOLDER #
QUOTE / ORDER # Q191523

PROJECT VALIDATION OVERALL PLAN



PROJECT VALIDATION

PRIVATE OFFICE | LINDA

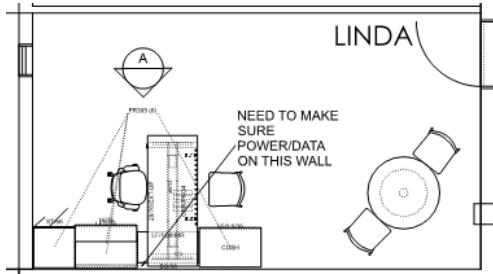

Elevation A

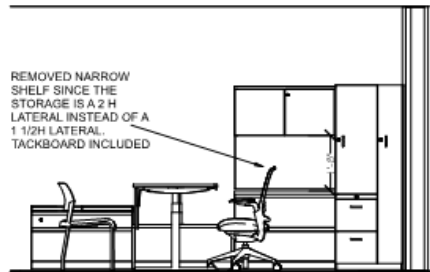

TASK CHAIRS NOT INCLUDED

OUTSTANDING

VISUALS



FINISHES

LAMINATE VIRGINIA WALNUT	CUSHION PENNANT CELLIANT 3861-901	FRAME PLATINUM	SHELL PLATINUM
PAINT FOG		FABRIC DTEX PENNANT 3861-901	

OPTIONS

- CURRENCY OVERHEAD
 - UNIVERSAL LOW STORAGE
 - TOWER TOO WARDROBE
 - MIGRATION HEIGHT ADJUSTABLE DESK, T LEG, EXTENDED, NO OVERHANG, UP/DOWN CONTROL, SQUARE EDGE
- STEELCASE MOVE CHAIR
 - HARD GLIDES

NOTE: Colors shown are not representative of actual finish. Please see or request a physical finish sample.

PROJECT VALIDATION

PRIVATE OFFICE | CASSANDRA

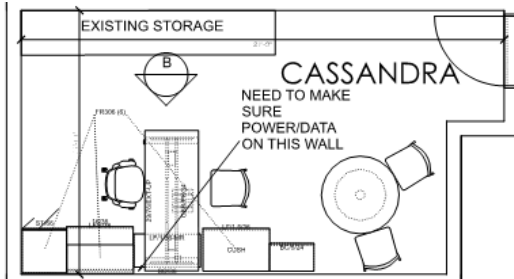

Elevation B

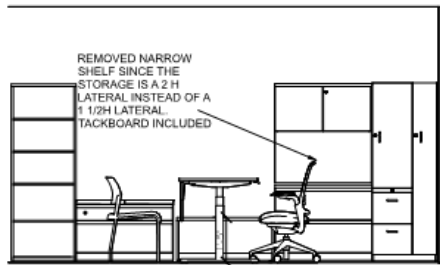

TASK CHAIRS NOT INCLUDED

VISUALS



FINISHES

LAMINATE VIRGINIA WALNUT	CUSHION PENNANT CELLIAN 3961-901	FRAME PLATINUM	SHELL PLATINUM
PAINT FOG		FABRIC DTEX PENNANT 3961-901	

OPTIONS

- CURRENCY OVERHEAD
 - UNIVERSAL LOW STORAGE
 - TOWER TOO WARDROBE
 - MIGRATION HEIGHT ADJUSTABLE DESK, T LEG, EXTENDED, NO OVERHANG, UP/DOWN CONTROL, SQUARE EDGE
- STEELCASE MOVE CHAIR
 - HARD GLIDES

OUTSTANDING

NOTE: Colors shown are not representative of actual finish. Please see or request a physical finish sample.

PROJECT VALIDATION

WELLNESS ROOM

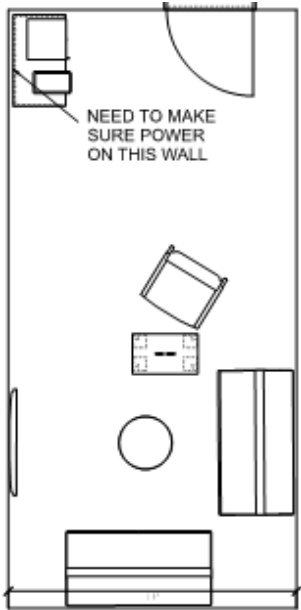







OUTSTANDING

VISUALS

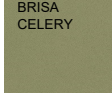

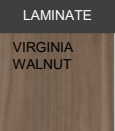
FINISHES

<p>ARM CAP</p> <p>CONCRETE</p> 	<p>PAINT</p> <p>PLATINUM METALLIC</p> 	<p>BACK</p> <p>DTEX FLUENT CHARCOAL</p> 	<p>SEAT</p> <p>BRISA CELERY</p> 
<p>FABRIC</p> <p>BRISA CELERY</p> 	<p>LAMINATE</p> <p>VIRGINIA WALNUT</p> 		

OPTIONS

- | | |
|----------------------------------------------------------------------------------------------------------------------------------------------------------------------------------------------------------------------|----------------------------------------------------------------------------------------------------------------------------------------------------------------|
| <p>NATIONAL WELI PATIENT CHAIR</p> <ul style="list-style-type: none"> • HARD GLIDES • WITH ARMS <p>CURRENCY DESK</p> <ul style="list-style-type: none"> • FULL HEIGHT MODESTY | <p>STEELCASE</p> <p>CAMPFIRE BIG LOUNGE</p> <p>CAMPFIRE PAPER TABLE</p> <ul style="list-style-type: none"> • WITH GLASS TOP • NO PAPER |
|----------------------------------------------------------------------------------------------------------------------------------------------------------------------------------------------------------------------|----------------------------------------------------------------------------------------------------------------------------------------------------------------|

NOTE: Colors shown are not representative of actual finish. Please see or request a physical finish sample.

PROJECT VALIDATION

BIG TABLE

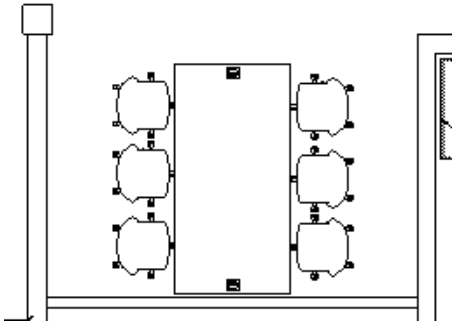

OUTSTANDING

VISUALS



FINISHES

PLASTIC JAZZ 6336	BASE PLATINUM 4799	TABLE VIRGINIA WALNUT 2535	POWER GROMMET FOG
----------------------	-----------------------	-------------------------------	----------------------

OPTIONS

STEELCASE SHORTCUT STOOL CAMPFIRE BIG TABLE 40H X 96W X 48D

NOTE: Colors shown are not representative of actual finish. Please see or request a physical finish sample.

PROJECT VALIDATION

BIVI & SCREENS

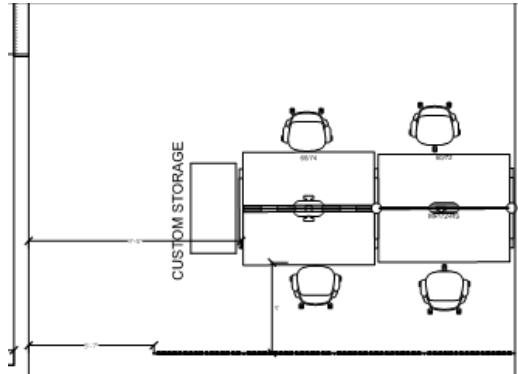

OUTSTANDING

CHAIRS NOT INCLUDED

VISUALS



FINISHES

PAINT FOG	SCREEN BILLIARD PEWTER 5H20	LAMINATE VIRGINIA WALNUT	HANGING PANEL VERVE FELT CELESTIAL FC5
PLASTIC PLATINUM	MODESTY BILLIARD CUMULUS	POWER ARCTIC WHITE GLOSS	

OPTIONS

- BIVI SIT STAND DESK
- 8 DUPLEX RECEPTACLES
- POWER STRIP – 2 DUPLEX, 2 USB
- AMQ HANGING PANELS - SHIMMER

NOTE: Colors shown are not representative of actual finish. Please see or request a physical finish sample.

PROJECT VALIDATION

IT AND MARKETING

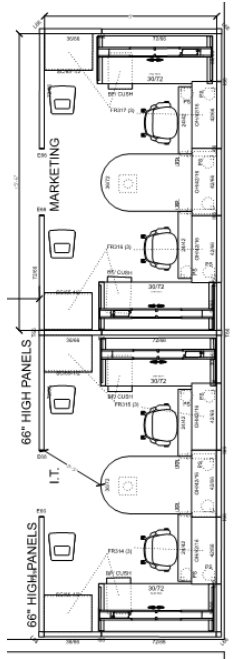

OUTSTANDING

- CHAIRS NOT INCLUDED

VISUALS

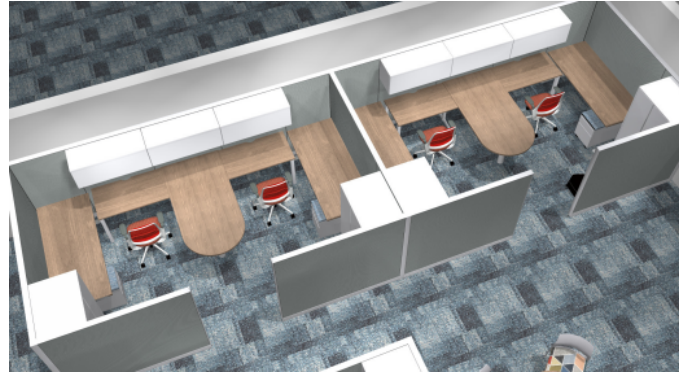

FINISHES

PAINT	SKINS
FOG	P204 NEW OPAL
PED CUSHION	LAMINATE
DTEX CHUNKY TWEED 3172-403	VIRGINIA WALNUT



OPTIONS

- STEELCASE ANSWER PANELS WITH LAMINATE SURFACES
- 24X42 WORKSURFACES WITH SCALLOP AND CORD DROP
- 30X72 WORKSURFACE NO SCALLOPS OR CORD DROP
- UNIVERSAL BIN IN THE CASE
- MOBILE PED WITH INTEGRAL PULL

CAMPFIRE FOOTREST

NOTE: Colors shown are not representative of actual finish. Please see or request a physical finish sample.

PROJECT VALIDATION

SORTERS AND CATALOGERS

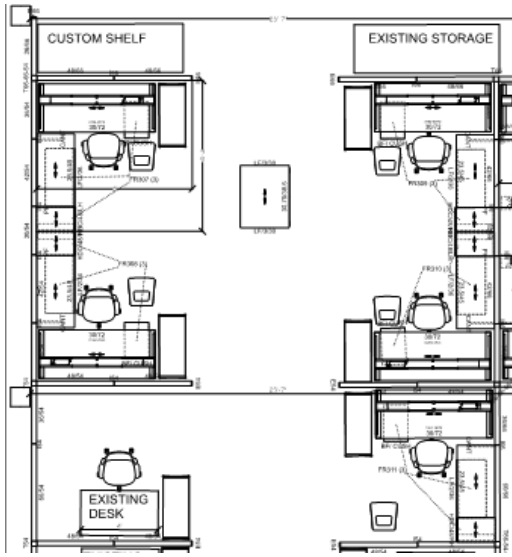

OUTSTANDING

- CHAIRS NOT INCLUDED

VISUALS



FINISHES

PAINT FOG	SKINS P204 NEW OPAL
PED CUSHION DTEX CHUNKY TWEED 3172-403	LAMINATE VIRGINIA WALNUT

OPTIONS

- STEELCASE ANSWER PANELS WITH LAMINATE SURFACES
- 30X72 WORKSURFACE NO SCALLOPS OR CORD DROP
- UNIVERSAL BIN IN THE CASE
- MOBILE PED WITH INTEGRAL PULL

PAINT	PLASTIC
PLATINUM METALLIC	PLATINUM SOLID
FABRIC DTEX PENNANT 3984-901	

- HD TOWER
- HD CABINET WITH SHELF AND COAT CLOSET
- NILE PULL

- MOVE CHAIR
- NO ARMS
- HARD GLIDES



PAINT	PLASTIC
PLATINUM METALLIC	PLATINUM SOLID
FABRIC DTEX PENNANT 3984-901	

CAMPFIRE FOOTREST

NOTE: Colors shown are not representative of actual finish. Please see or request a physical finish sample.